



Mounting Instruction Triumph Classic Dash Board (309013)



Installation time : 150 minute

Tools requirement:

- 1) Allen wrench 4 mm.
- 2) Open-end box 8 mm.
- 3) warmed gun
- 4) Screwdriver set
- 5) Medium Thread Locker



Telefono 0039 (0) 445-390437
Fax 0039 (0) 445-395539

Email info@freespirits.it
Site: www.freespirits.it

ATTENTION !

Disconnect the negative battery terminal

FOR SINGLE INSTRUMENT MODELS



Remove the shell of the speedometer.
Disconnect the plug and remove the speedometer.



Remove the bracket and the shell as shown.
Pull the plug.

FOR MODELS WITH REV COUNTER

3



Remove OEM bracket and shell.

4



Pull the plug and remove instruments.



5

Apply O-ring on speedometer.



6

Insert the speedometer on the new bracket.



7

Insert buttonhead screws on brackets as technical draw (See page 12).

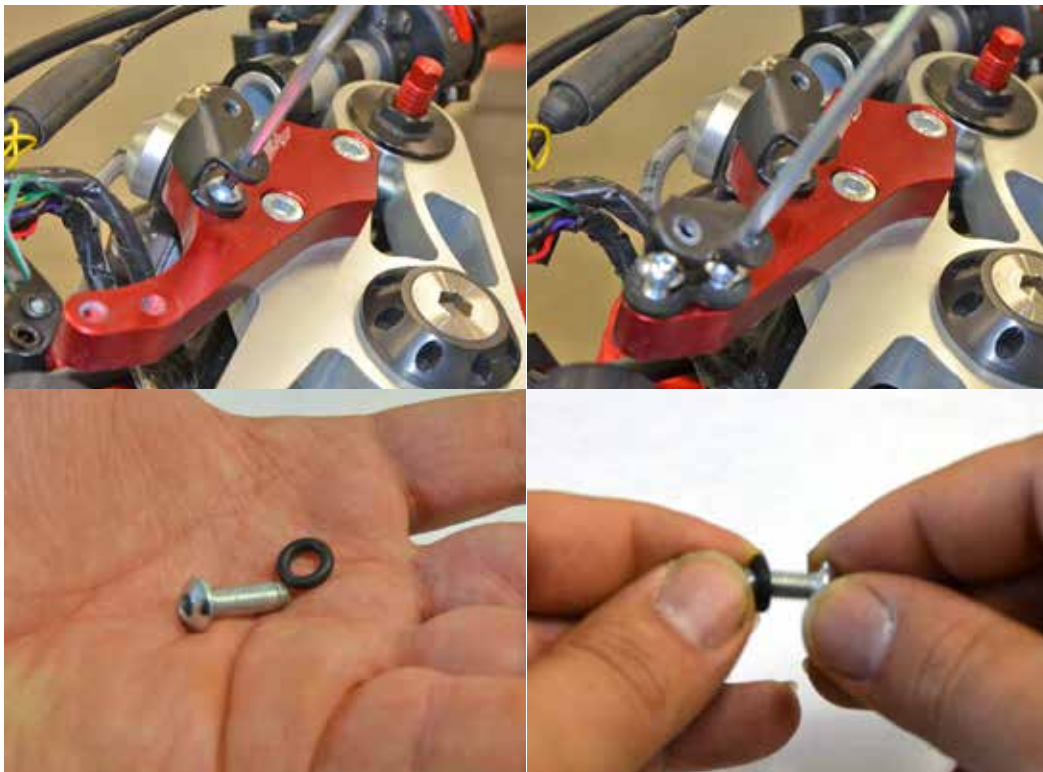

8

Mount the brackets on the original plate.
Place the O-rings on the screws M6x20 buttonhead.

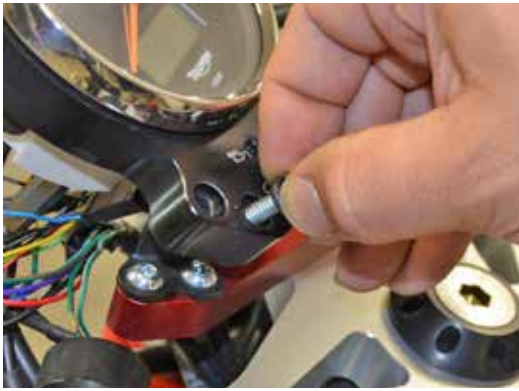

9

Attach the new support.



10

Pay close attention to the numbers on the "Brown" plug and the drawing on page 8 will be useful to proceed with the installation.

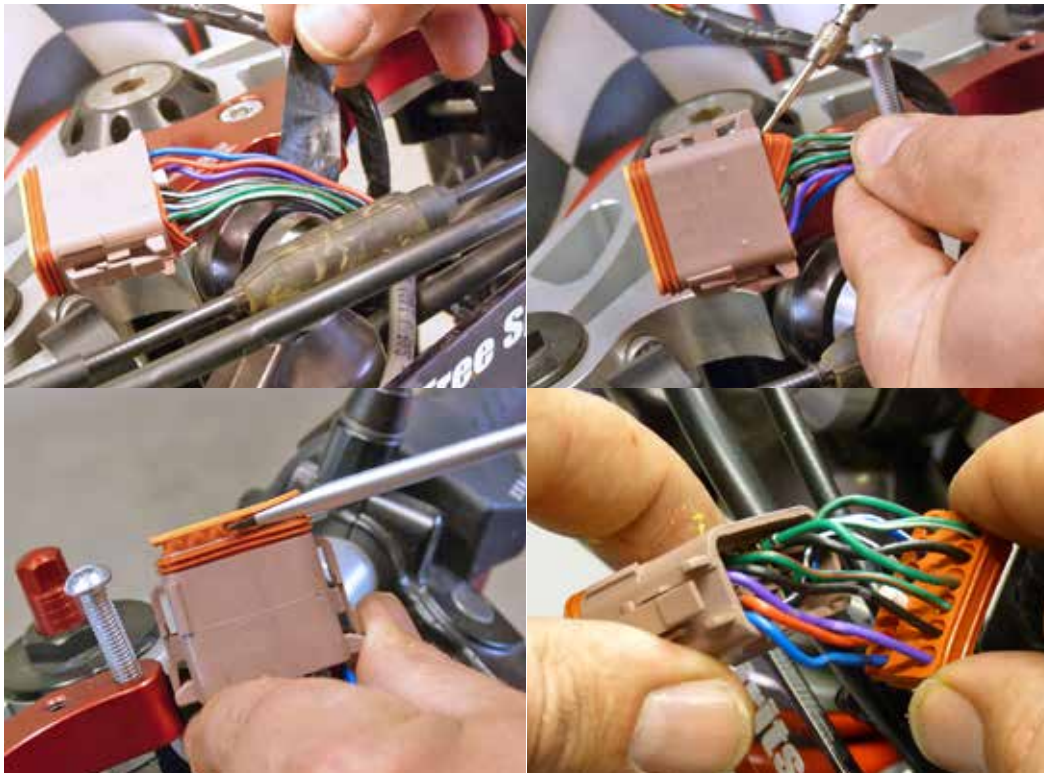

11

Slide off the gasket and the front cap of the plug.

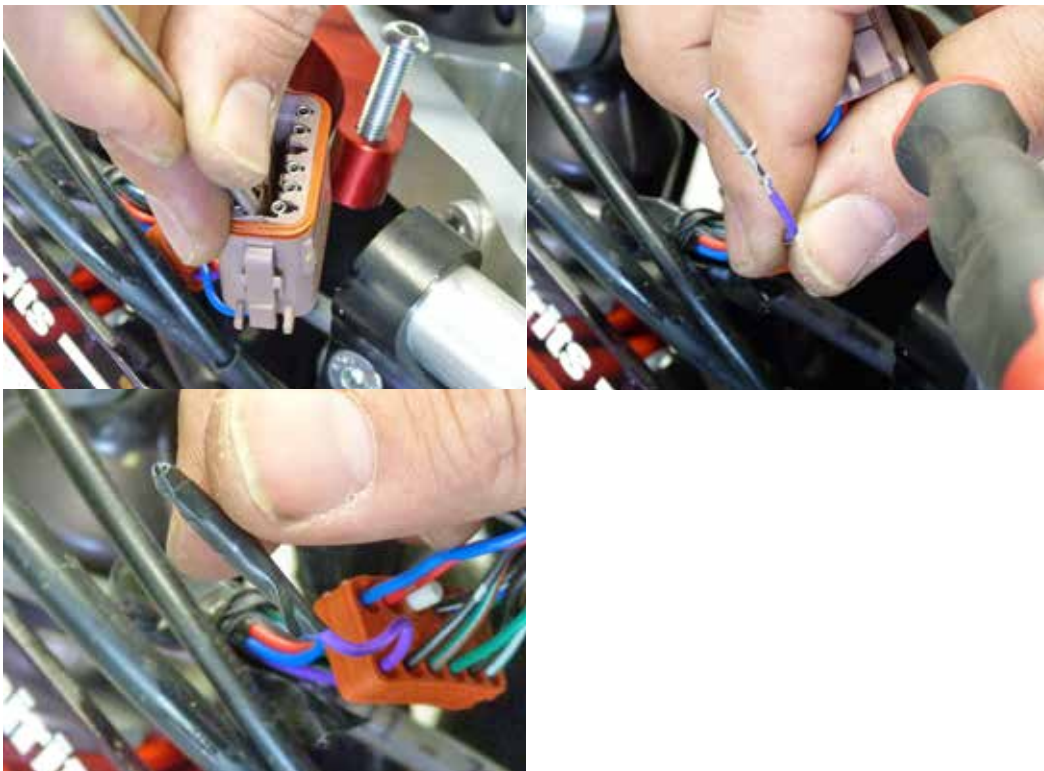

12

With a small screwdriver remove the connectors from the plug.

First remove the wires that will not be used, and isolate (example purple wire) always refer to page 9

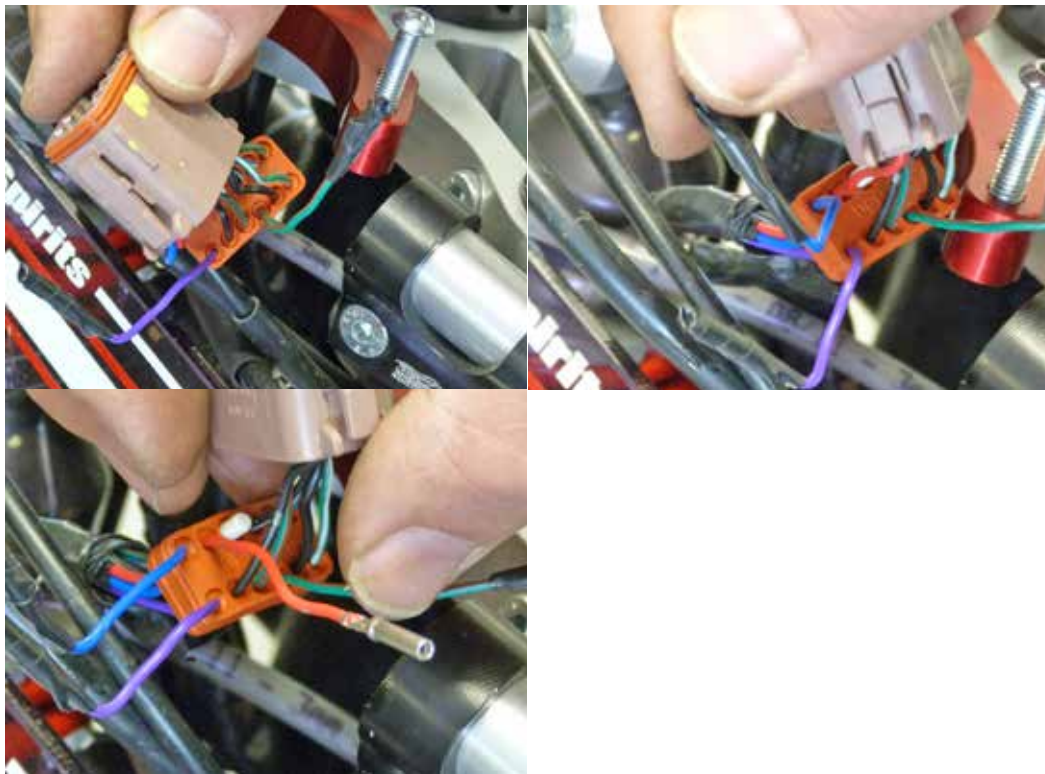

13

Proceed with the wires 4 red / green, 12 blue, 11 red.
See Page 9.

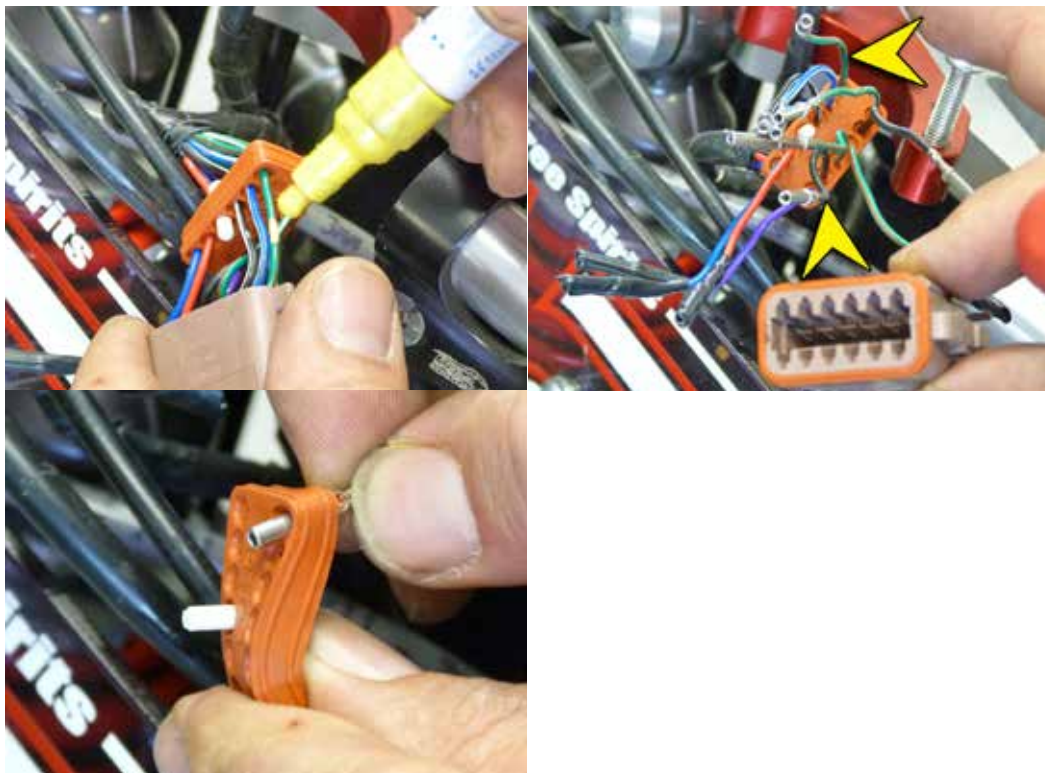

14

Mark the wires: 7 red / green, 2 Black for not to confuse them with others of similar color.
Slide off the remaining wires from the gasket.

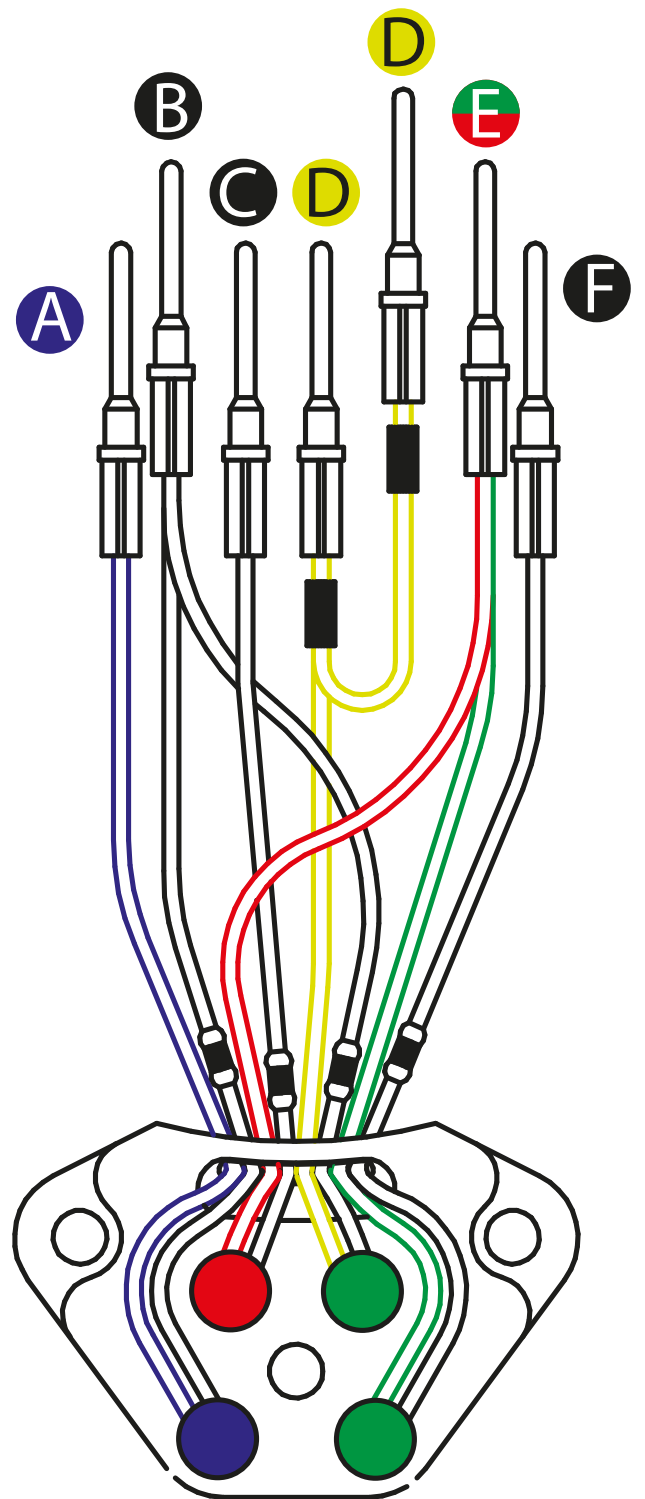
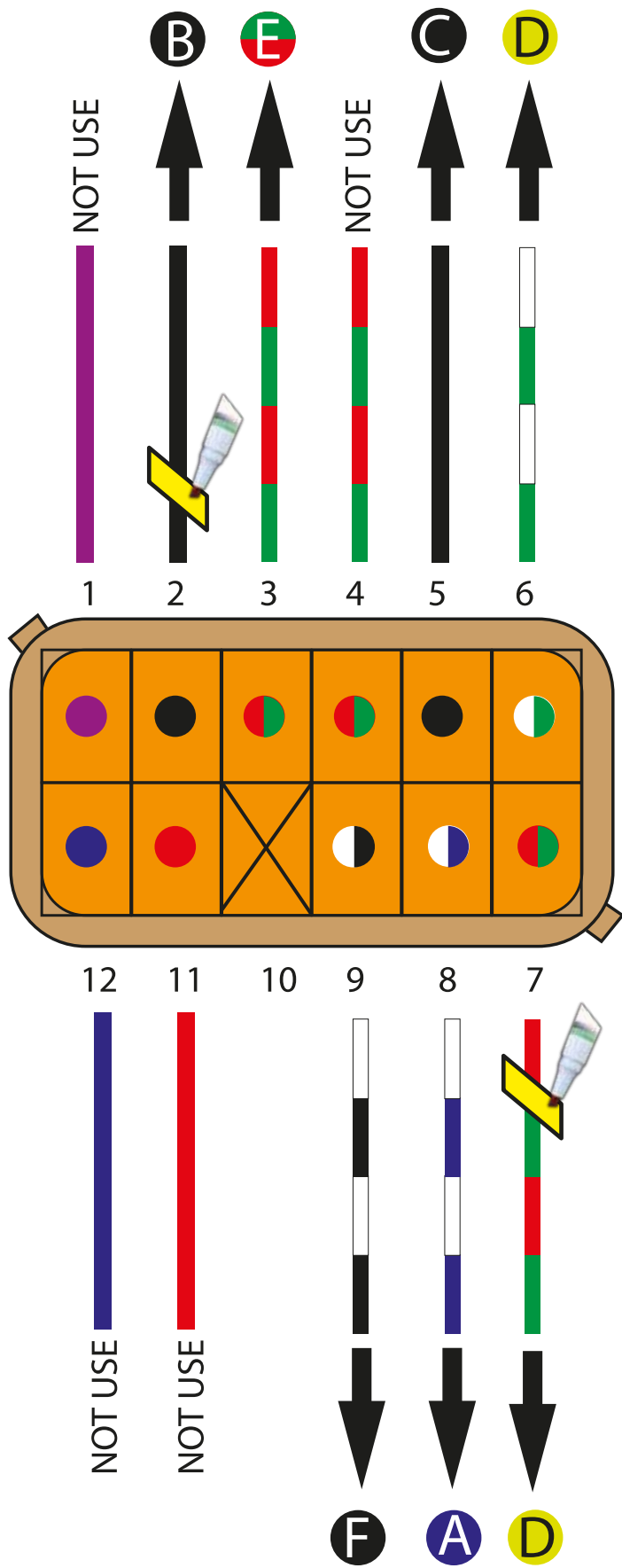

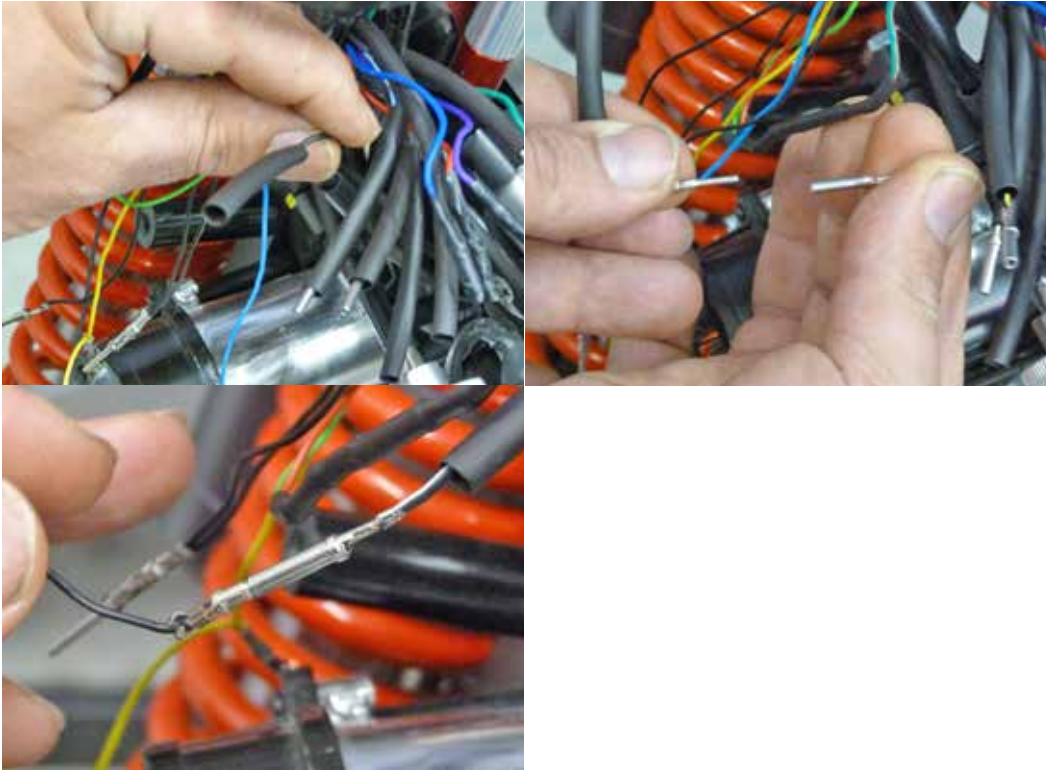

15

Slide shrink tubing on uninsulated wires.
Now connect the pins of the new instrument panel,
following the diagram on p. 8.



16

Once connected all the plugs warm up to block and
isolate all.

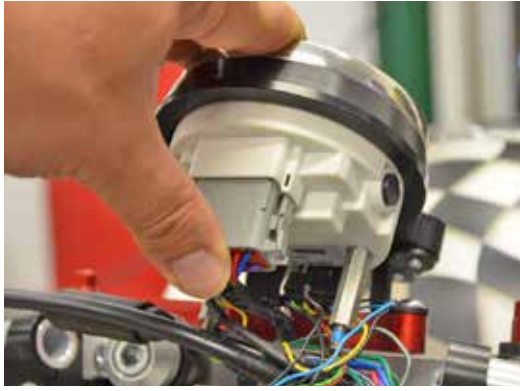

17

Insert the gray plug on the speedometer.
Place wiring underneath the speedometer



18

Put the cover underneath the speedometer.
Apply thread lock medium to the oem nuts.
Tighten the nuts up to support the plastic shell
without forcing it.
Wait 15 to 45 minutes. before operating the vehicle.

